

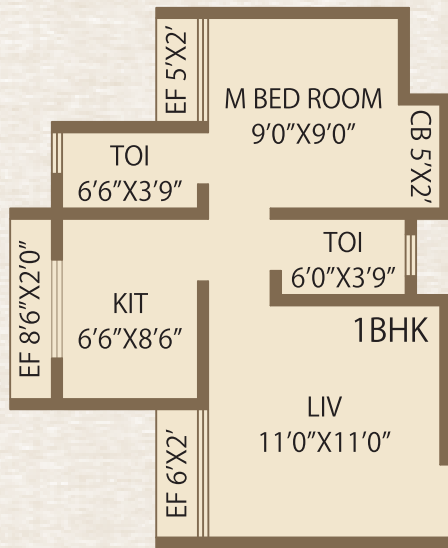

Property
Investment
Now So
Simple

with Option to Purchase



▶ Invest 50% of Flat Cost ◀

Get Rent

Rs. 6,250/-
Monthly

Area Description	RERA CARPET	= 343.90
	ELEVATION FEATURES	= 38.42
	TOTAL USEABLE AREA	= 382.32
	STAIR+LOBBY+OTHER	= 217.68
600	TOTAL CONSTRUCTION AREA	= 600.00

Proposed Launching On or before 18 Months - Rs. 36.30 Lacs Minimum.

Investor's privilege Price - Rs.30.00 Lacs - till Completion of Plinth

Investment Amount (50%) Rs.15,00,000/-	Receive Monthly Rs.6,250/- through 18 PDCs	Min Gross Sale Benefit Rs.6.30 Lacs	Total Received by Monthly Benefit Rs.1.12 Lacs (A)	Net Sale Benefit 50:50 Rs.5.17 Lacs	Investor's Profit Share Rs.2.58 Lacs (B)	Developer's Profit Share Rs.2.58 Lacs
-------------------------------------------	---------------------------------------------------------	----------------------------------------	-------------------------------------------------------	----------------------------------------	---------------------------------------------	------------------------------------------

Investor's Minimum Net Benefit Rs.3.71 Lacs (A+B)

घर हो तो ऐसा®

Original... Since 1998

*Above Figures and Plan are Indicative, only for investors survey before launch of fully furnished flat.